

MELVILLE J. HERSKOVITS
Library of African Studies

GUIDE TO THE BOOK STACKS

- 0 Entrance
- 1 Reference Desk & NUCat Workstations
- 2 Index Table / Card Catalog
- 3 Bibliographies
- 4 Africana Reference Books
- 5 Extended Bibliographies
- 6 Current Periodicals (open shelves)
- 7 Current Periodicals (closed cases) & Language Books
- 8 Regular Sized Books (300s, 700s, 800s, 900s)
- 9 Regular Sized 300s
- 10 "Gold Section" (Regular Sized Overflow of 300s, 800s and 900s)
- 11 Regular Sized 900s Overflow
- 12 Large Books (300s, 700s, 800s, 900s through 967)
- 13 Large 967s Overflow
- 14 Large 966s & 967s Overflow
- 15 Folios
- 16 Vertical Files
- 17 Sample Files
- 18 Public Printing Workstation
- 19 Curator (room 5692)
- 20 Bibliographer of Africana (room 5688)
- 21 Librarian of Africana (room 5674)
- 22 Francophone Bibliographer (room 5676)
- 23 Main Office (room 5602)
- 24 Library Assistant Desk
- 25 Exhibit Cases
- 26 Staircase / Rear Exit

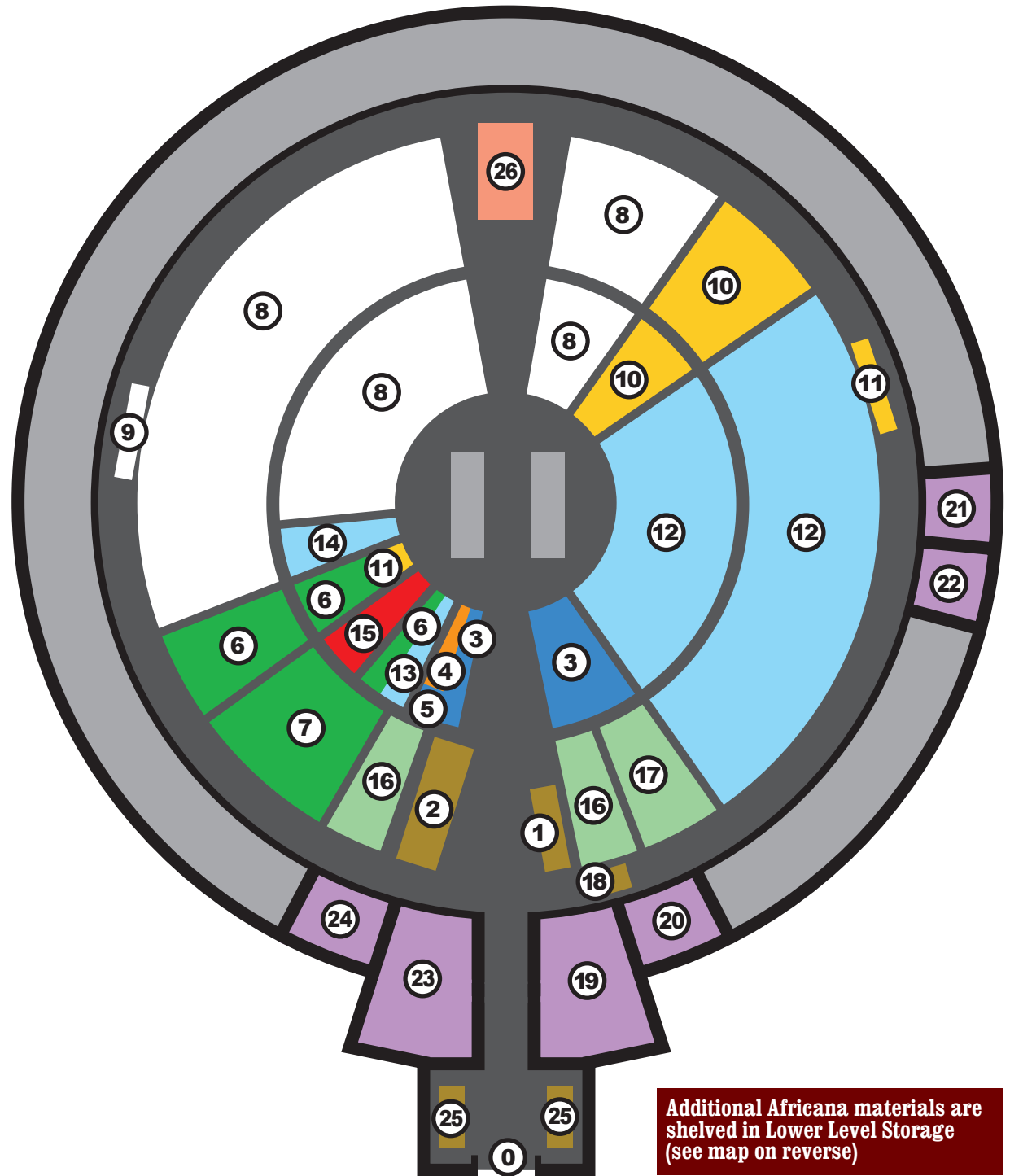

Additional Africana materials are shelved in Lower Level Storage (see map on reverse)

LOWER LEVEL Location Guide

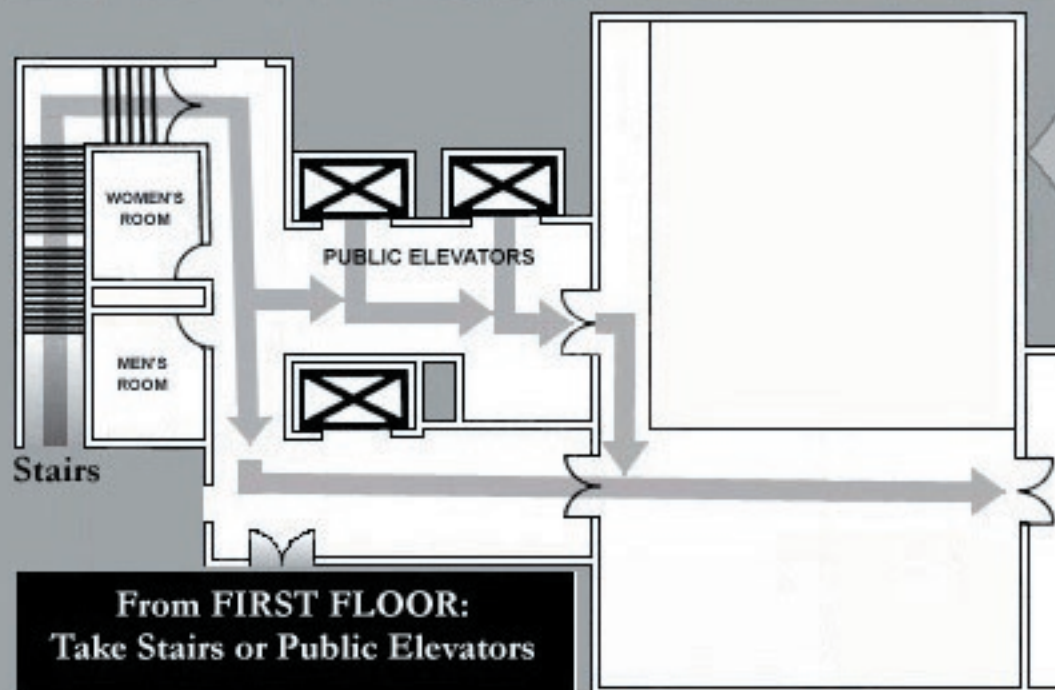

B238
B249

- | | |
|--|--|
| 1 <input type="checkbox"/> LARGE misc Jour | 10 <input type="checkbox"/> LARGE LLS Africana |
| 2 <input type="checkbox"/> LARGE 370-379 | 11 <input type="checkbox"/> Africana phone books |
| 3 <input type="checkbox"/> LARGE 380-389 | 12 <input type="checkbox"/> Africana calendars |
| 4 <input type="checkbox"/> LARGE 650-659 | 13 <input type="checkbox"/> LLS Africana books |
| 5 <input type="checkbox"/> misc Journals | 14 <input type="checkbox"/> Africana Newspapers |
| 6 <input type="checkbox"/> Main 370-379 | 15 <input type="checkbox"/> LLS Transportation |
| 7 <input type="checkbox"/> Main 380-389 | 16 <input type="checkbox"/> Dissertations |
| 8 <input type="checkbox"/> Main 650-659 | 17 <input type="checkbox"/> Africana overflow |
| 9 <input type="checkbox"/> empty | 18 <input type="checkbox"/> Africana reshelving |

